







# E140AN10

 Single layer	
 Manual centring	 2 Heating zone(s)
 Die adjustment	 Tip adjustment

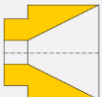
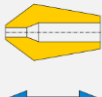
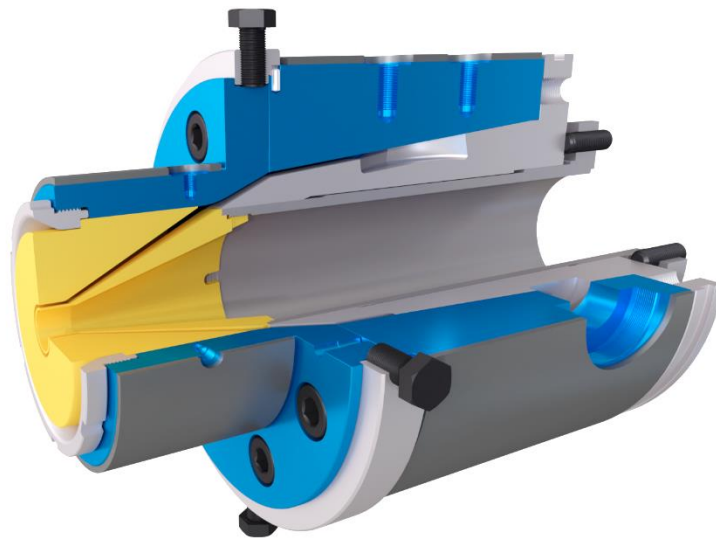



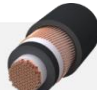
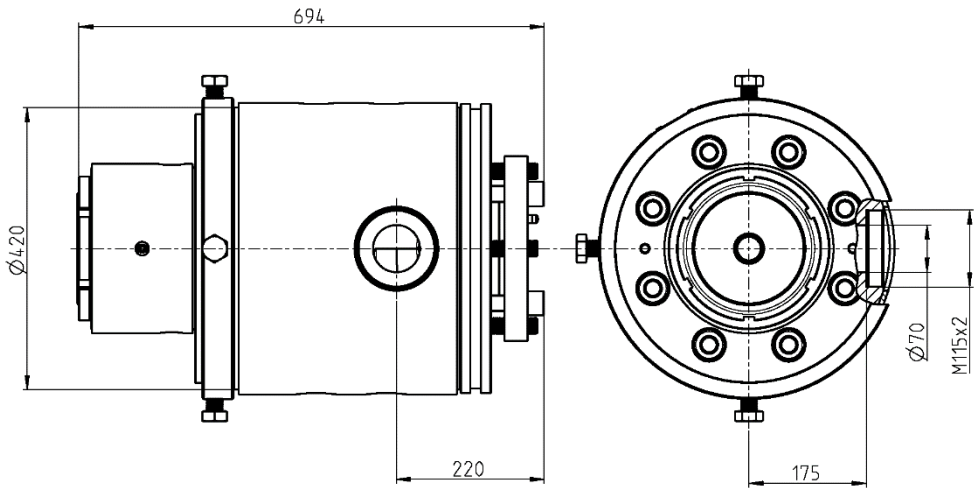



-  Power cable
-  Data cable
-  Special shaped
-  Tube
-  HV/MV cable

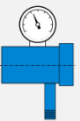

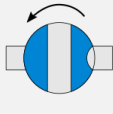
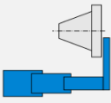
Version	Maximum opening of the Tip	Maximum opening of the Die	Main entry port / thread		Auxiliary entry port / thread		Total length	Crosshead diameter	Max. working temperature	Max. working pressure	Weight
			A	B	C	D					
-	140 mm	150 mm	70 mm	M115x2	-	-	694 mm	420 mm	<250°C	400 bars	490 kg

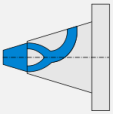
## Options

 Vacuum connection	 Extruder connection	 Bypass module	 Telescopic maintenance device	 Trolley or stand	 Customized distributor	 300°C Reinforced heaters			
--	--	--	--	---	---	--	--	--	--