







E4BF10 FT

 Single layer	
FT Fine-tuning centring	3  Heating zone(s)
 Die adjustment	

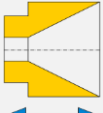
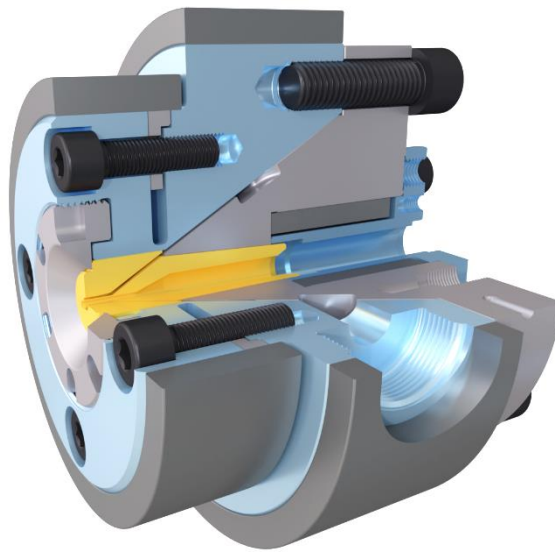

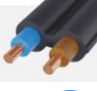

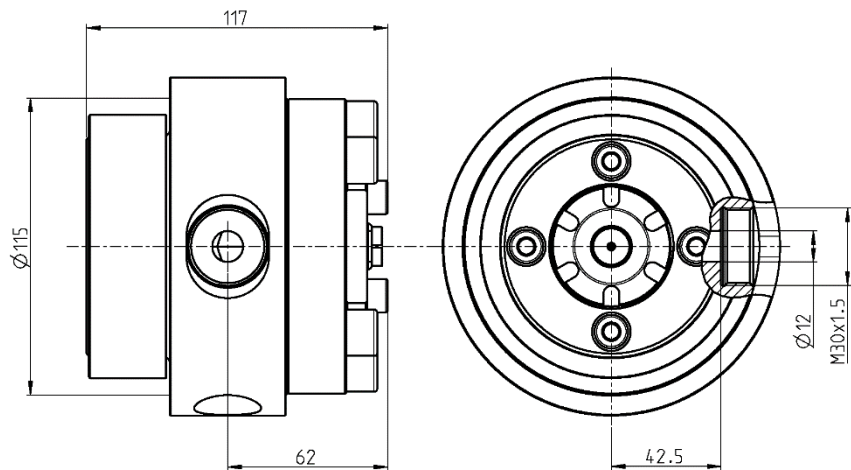

Power cable	
Data cable	
Special shaped	
Tube	

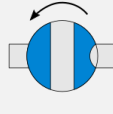
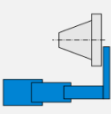

Version	Maximum opening of the Tip	Maximum opening of the Die	Main entry port / thread		Auxiliary entry port / thread		Total length	Crosshead diameter	Max. working temperature	Max. working pressure	Weight
			A	B	C	D					
-	7 mm	11 mm	12 mm	M30x1.5	-	-	117 mm	115 mm	<400°C	300 bars	8 kg

Options

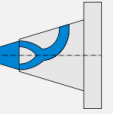
 Vacuum connection	 Extruder connection	 Bypass module	 Telescopic maintenance device	 Trolley or stand	 Customized distributor				
--	--	--	--	---	---	--	--	--	--