









# E4BF11

 Skin coloration	 Striping
 Single layer	
 Fix centring	 3 Heating zone(s)
 Die adjustment	

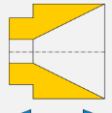
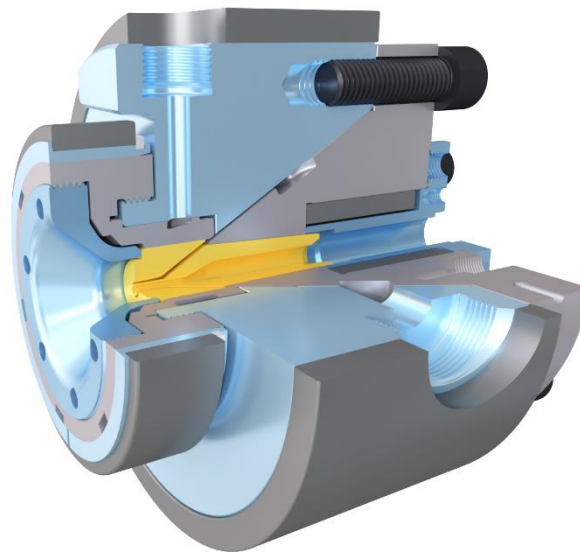



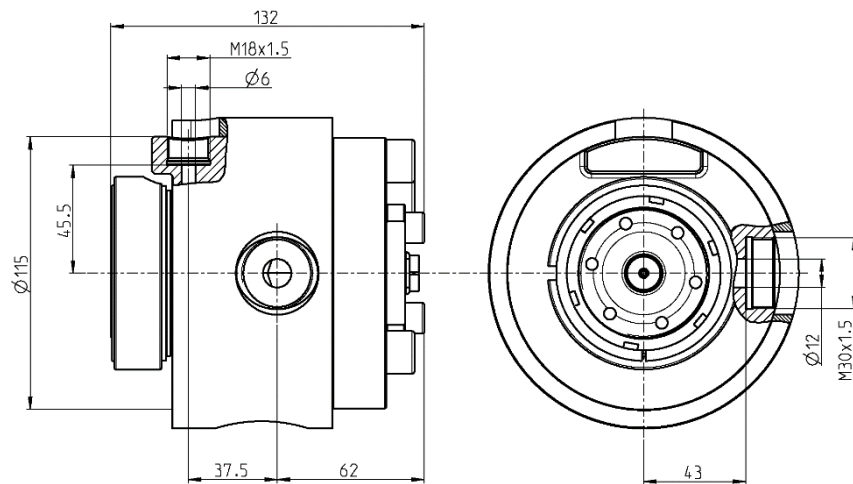

- Power cable 
- Data cable 
- Special shaped 
- Tube 

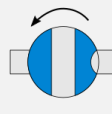
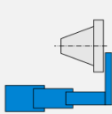

Version	Maximum opening of the Tip	Maximum opening of the Die	Main entry port / thread		Auxiliary entry port / thread		Total length	Crosshead diameter	Max. working temperature	Max. working pressure	Weight
			A	B	C	D					
-	7 mm	11 mm	12 mm	M30x1.5	6 mm	M18x1.5	132 mm	115 mm	<400°C	300 bars	9 kg

## Options

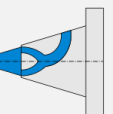
 Vacuum connection	 Extruder connection	 Bypass module	 Telescopic maintenance device	 Trolley or stand	 Customized distributor					
--	--	--	--	---	---	--	--	--	--	--