







E4BN10 FT

 Single layer	
FT Fine-tuning centring	2+  Heating zone(s)
 Die adjustment	

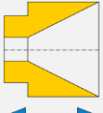
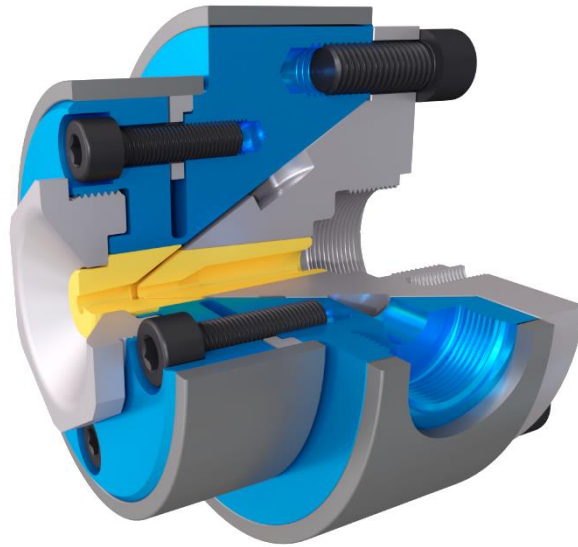



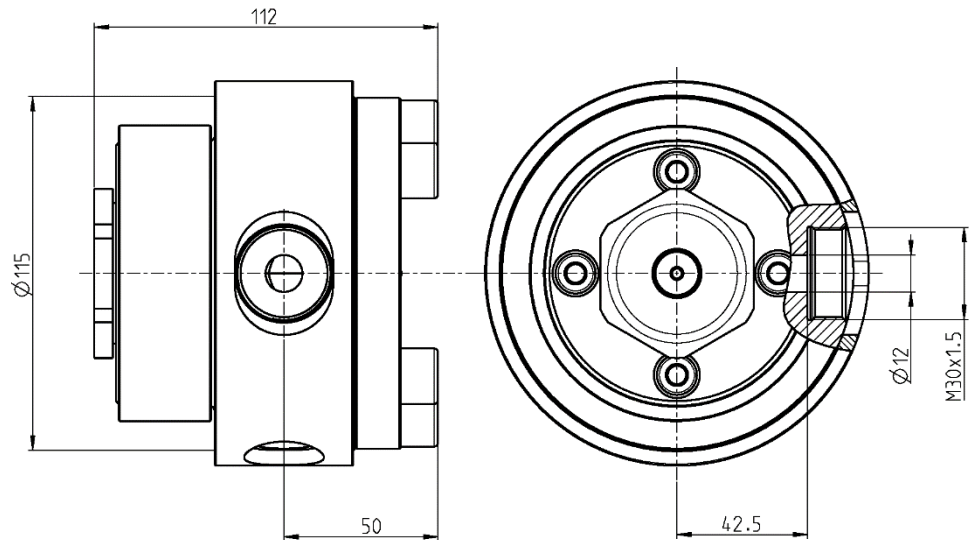



Power cable	
Data cable	
Special shaped	
Tube	

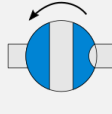
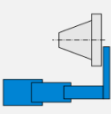

Version	Maximum opening of the Tip	Maximum opening of the Die	Main entry port / thread		Auxiliary entry port / thread		Total length	Crosshead diameter	Max. working temperature	Max. working pressure	Weight
			A	B	C	D					
-	7 mm	11 mm	12 mm	M30x1.5	-	-	112 mm	115 mm	<250°C	600 bars	8 kg

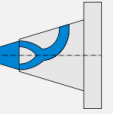
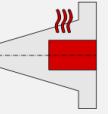
Options

 Vacuum connection	 Extruder connection	 Bypass module	 Telescopic maintenance device	 Trolley or stand	 Customized distributor	 Heated distributor	 300°C Reinforced heaters		
--	--	--	--	---	---	--	---	--	--