









# E4BN11

 Skin coloration	 Striping
 Single layer	
 Fix centring	 2+ Heating zone(s)
 Die adjustment	

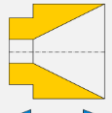
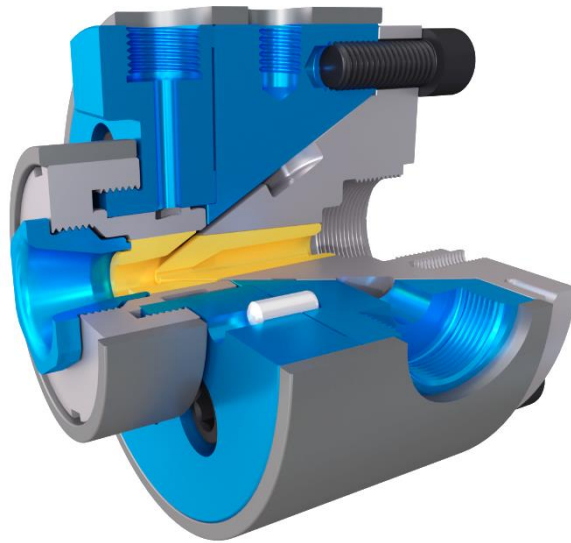



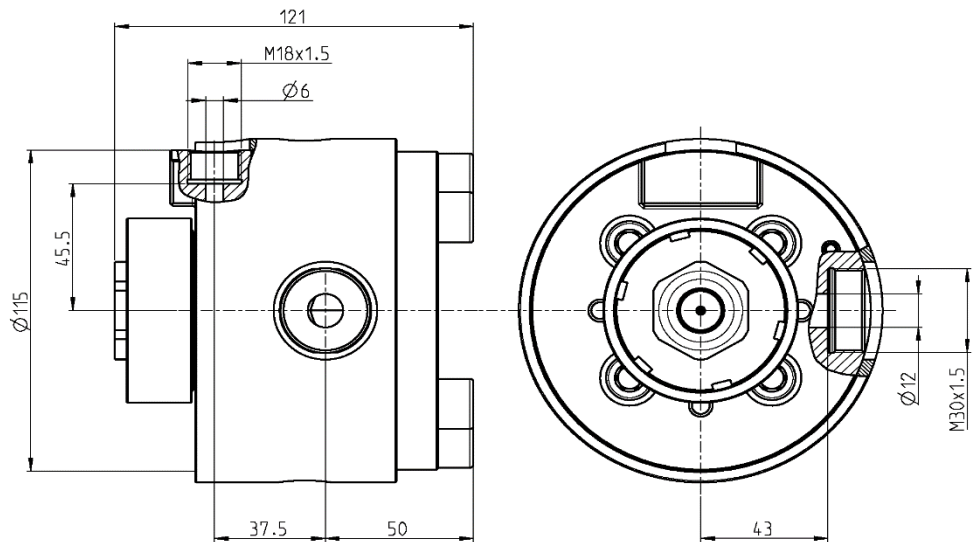



Power cable	
Data cable	
Special shaped	
Tube	

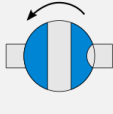
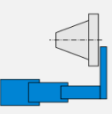

Version	Maximum opening of the Tip	Maximum opening of the Die	Main entry port / thread		Auxiliary entry port / thread		Total length	Crosshead diameter	Max. working temperature	Max. working pressure	Weight
			A	B	C	D					
-	7 mm	11 mm	12 mm	M30x1.5	6 mm	M18x1.5	121 mm	115 mm	<250°C	600 bars	7 kg

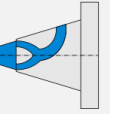
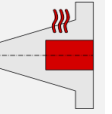
## Options

 Vacuum connection	 Extruder connection	 Bypass module	 Telescopic maintenance device	 Trolley or stand	 Customized distributor	 Heated distributor	 300°C Reinforced heaters		
--	--	--	--	---	---	--	---	--	--