









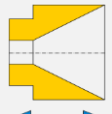
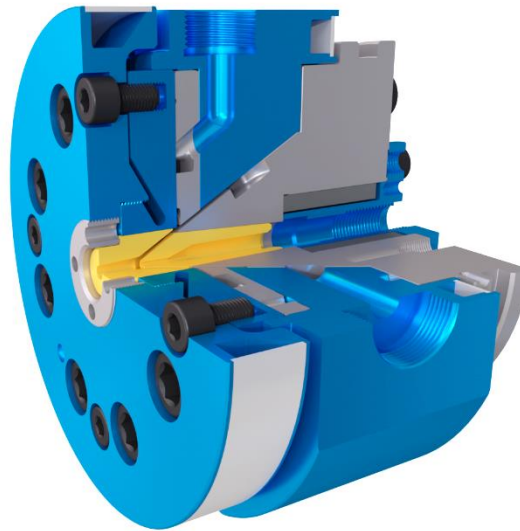

E4JN20

 Skin coloration	 Striping
 Single layer	
FT Fine-tuning centring	 2+ Heating zone(s)
 Die adjustment	



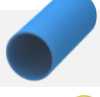
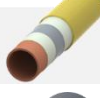

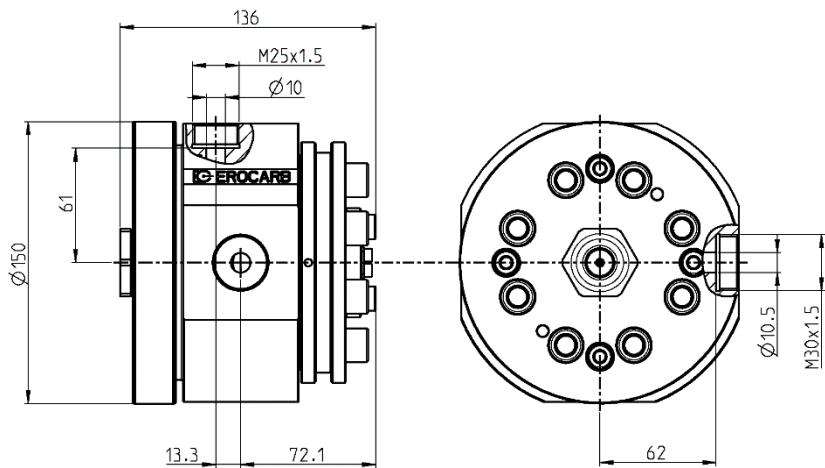

Power cable	
Data cable	
Special shaped	
Tube	
Multi-layer tube	
Foamed cable	

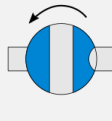
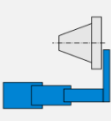

Version	Maximum opening of the Tip	Maximum opening of the Die	Main entry port / thread		Auxiliary entry port / thread		Total length	Crosshead diameter	Max. working temperature	Max. working pressure	Weight
			A	B	C	D					
-	7 mm	11 mm	10.5 mm	M30x1.5	10 mm	M25x1.5	136 mm	150 mm	<400°C	600 bars	14 kg

Options

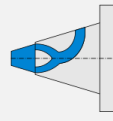
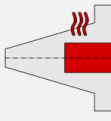
 Vacuum connection	 Extruder connection	 Bypass module	 Telescopic maintenance device	 Trolley or stand	 Customized distributor	 Heated distributor				
--	--	--	--	---	---	--	--	--	--	--